

A custom wine rack hides a convenient washer-dryer.

This paneled wine fridge has three (!) temperature zones.

THE TASTING ROOM

—
by
JEAN LIU DESIGN

One too many doorways can turn a room into a de facto hallway that's passed through rather than used. But for this space that opens onto the home's media room and office, Dallas-based designer Jean Liu of Jean Liu Design knew the perfect solution: "So many of my clients have been asking for entertaining spaces where they can display their wine—or collections of mezcal and tequila—separate from their dining or living rooms," she says. Inspired by heart-shaped origami (something she and her daughter make together often), she designed an inviting banquette with room for friends, perfect for perching under a window with a glass of something delicious. A bespoke wine rack made from brass dowels and burgundy leather displays 20 bottles and disguises a handy laundry closet.

Rug: [The Rug Company](#). Banquette fabric: [S. Harris](#). Lighting: [Circa Lighting](#). Wine fridge: [Signature Kitchen Suite](#). Ceiling paint: [Farrow & Ball](#). Table: [Jiun Ho](#). Stools: custom, [Jean Liu Design](#). Artwork: [Celia Rogge Photography](#) (in wet bar); José Lerma (above banquette). Wine rack leather: [Fabricut](#).



An origami-inspired corner bench is surrounded by art from AAPI creators, such as this piece by New York-based Kyung-Me.

▼
WET BAR

Just off the tasting room, a cocktail station is equipped with a dishwasher, three-zone wine fridge (not shown), and double refrigerator drawers (each of which can be independently set to five temperatures, from 50° F for pantry goods to freezing). A quartz backsplash and countertop create a worry-free workspace for cutting lemons and limes and opening red wine. **Appliances:** [Signature Kitchen Suite](#). **Countertop and backsplash:** [Caesarstone](#). **Fixtures:** [Elkay](#). **Tile:** [Exquisite Surfaces](#).



THE BREEZEWAY

by JEAN LIU DESIGN

A covered passageway connecting the three-car garage, main house, and secondary wing could have been an afterthought. But by reimagining it as an outdoor dining room, Liu capitalized on the view. Motorized retractable screens allow the breeze to come through and keep the critters out.

Lighting: [Circa Lighting](#). **Rug:** [Fibreworks](#). **Art:** framed wallcovering, [Phillip Jeffries](#). **Fabric:** [Perennials](#). **Furniture:** [Sutherland](#). **Exterior paint:** [Farrow & Ball](#). **Tabletop:** [Carol Hicks Bolton Antiquities](#) and [Blackchalk Home and Laundry](#).



TRUNDLE BED

The canopied daybed has a hidden trundle underneath, creating a cocoon for reading or sleeping in this unconventional media turned guest room.
Bedding: [TENCEL](#), [Macy's Oake](#). **Mattress:** [Stearns and Foster](#).

THE
 JEWEL BOX
 —
 by
 FRENCH &
 FRENCH INTERIORS

A room that accommodates movie nights and Spades tournaments is bound to be buzzing in the wee hours, so you'd be wise to prepare for on-site sleepovers. Wife-and-husband duo Heather and Matt French, of Santa Fe's French & French Interiors, splashed this media room in bold pattern, dramatic color, and tons of texture, then crowned the design with a curtained trundle bed for drifting off into dreamland. "This whole end of the house is a place where grandkids or guests can hang out, play games, share stories, just be connected," says Matt. In order to ensure this tiny, busy room always looks neat, they added closed-door, trellis-inspired cabinets to hide everything from board games to bedding. "I hope the owners use this room every day. That it becomes a space to disconnect in order to reconnect with each other, and that their guests feel special in it," says Heather. "It's a little boutique room built just for them."

Drapery and ottoman fabric: Iris Apfel for [Fabricut](#). **Lighting:** [Circa Lighting](#). **Rug:** [The Rug Company](#). **Paint:** [Farrow & Ball](#). **Art:** [Field Studies Editions](#). **Bulbs:** [Cync](#). **Wallcovering:** [Phillip Jeffries](#).

GUEST BATHROOM

Heather and Matt carried forward the striking green from the main room into this adjoining bath, pairing it with mixed brass, black, and polished nickel, and an arched backsplash and mirror behind the console sink. **Fixtures:** [Signature Hardware](#). **Towels:** [TENCEL](#), [Macy's Oake](#). **Paint:** [Farrow & Ball](#). **Lighting:** [Circa Lighting](#). **Backsplash:** [Caesarstone](#). **Rug:** [Serena & Lily](#).

READING ZONE

Opposite the daybed, a curved-back sofa offers a comfy spot for evening catch-ups. **Sofa:** [Arhaus](#). **Lighting:** [Circa Lighting](#).





WINDOW SEAT
 Fresh white walls and simple upholstered cushions frame the greenery outside. **Bookcase wallcovering:** Phillip Jeffries. **Metal cabinet fronts:** Architectural Grille. **Pillow and cushion fabric:** Fabricut. **Window treatments:** The Shade Store.



HOME GYM
 This solid pine piece is part suspension trainer, part plant holder, while the top of the custom desk can be removed to create aerobic modular steps. **Shelves:** Shelfology. **Shelf art:** Maddie Moritz. **Desk "steps":** Grothouse.



Hiding here is a backless chair that promotes better posture.

THE FLEX SPACE

by LAURA HODGES STUDIO

The cure for hunching over a desk for hours on end? A quick, invigorating sweat. In creating a productivity-inspiring home office, Baltimore-based designer Laura Hodges of Laura Hodges Studio decided to make it double as a no-pressure workout room. "Having the two-in-one room is not only dual-purpose, but it also makes sure that you're using the space," she explains. "It's not just a home office that you sometimes use and otherwise goes unused." This one is meant to actually be good for your mental as well as physical health: Hodges designed it as a biophilic space, adding plants in every little corner and materials like wood-veneered wall paper and a natural hemp rug. Velvet cushions can be tossed on the floor for a blissful midafternoon meditation, while the custom desk easily comes apart to function as a set of aerobic steps. The room is intentionally Zen—and noticeably free of any guilt-inducing treadmills or bikes. "We brought in pieces that you want to look at, even if they do remind you to work out," says Hodges.

Lighting: Circa Lighting. **Bulbs:** Cync. **Paint:** Farrow & Ball. **Rug:** Fibreworks. **Plants:** Bloomscape and Walmart. **Desk and console:** Grothouse. **Chairs:** Chairish. **Woven accessories:** Kazi. **Other accessories:** DOMAIN by Laura Hodges Studio. **Architectural drawings:** Alyssa Dennis. **Desk chair:** Icaria Design.

THE OWNERS' RETREAT
—
by TOLEDO GELLER

"It's like you're on safari. This is not what we expected in Texas," says Virginia Toledo of the view of rolling hills and wandering wildlife outside. She and her partner, Jessica Geller, at Toledo Geller in Franklin Lakes, New Jersey, designed the intimate main bedroom and connected bath as a total celebration of that landscape. "We quickly decided to take the idea of a modern farmhouse that honors the location and show that this style can be more than black and white," Geller explains. The pair used a mustard wallcovering made of linen and paper, then added in touches of tobacco browns, milky creams, and pale pinks. The whitewashed vaulted ceiling and contrasting beams give the room an expansive feel, so they balanced that with an upholstered canopy bed and plaster chandelier. A custom wool woven rug, designed to fit around the fireplace, was topped with a plush merino rug perfect for stepping onto right out of bed.

Lighting: Circa Lighting. **Bed fabric:** Fabricut. **Wallcovering:** Phillip Jeffries. **Bedding:** TENCEL, Pottery Barn. **Weighted throws:** TENCEL, Bearaby. **Mattress:** Stearns and Foster. **Rugs:** The Rug Company (top, shown below) and Fibreworks (bottom, shown at right). **Bed:** custom, Toledo Geller. **Side tables:** Bungalow 5.



< **BEDROOM**
Private access to the pool makes a morning dip nonnegotiable. **Chair fabric:** S. Harris. **Drapery and ottoman fabric:** The Vale London. **Fabricut.** **Vase:** Arteriors. **Door handle:** Schlage.

v **EN SUITE BATH**
A linen wallcovering in a relaxing, washed-out blue blends with the sky view. Large-scale floor tiles were cut to size to create this classic pattern. **Fixtures:** Signature Hardware. **Wallcovering:** Phillip Jeffries. **Decanters:** Arteriors.

v **BATHROOM VANITY**

Toledo Geller used white oak cabinetry, grasscloth, and a quartz countertop that looks like concrete to impart earthiness, while petite sinks allow for more counter space and elbow room. **Lighting:** Circa Lighting. **Sculpture:** Arteriors. **Countertop:** Caesarstone.





OWNERS' DEN

A classic double-tiered chandelier helps make the tall room feel cozy. "This is where the owners go to detach from the rest of the home. They can just curl up with a blanket, enjoy a cup of tea, and let go of the day," says Welch.



THE HIDEOUT

by
MIKEL WELCH DESIGNS

"This was the perfect opportunity for the owners to have a space of their own that's not a bedroom and not an office," says Mikel Welch, owner of his eponymous New York firm. The cozy sitting room is right down the hall from the main bedroom and bath, tucked away in a private wing of the house. **For the intimate space, Welch created a "cave-like" energy by bathing every surface in palate-cleansing neutrals.** A plush, handwoven wool rug feels great barefoot, while a deep oversize sofa and two nubby bouclé swivel chairs are ideal for a late afternoon read—that turns into a late afternoon nap.

Furnishings, accessories, and wall-coverings: Arhaus. Window treatments: The Shade Store. Brick wall: Acme Brick. Lighting: Circa Lighting. Tea set: Blackchalk Home and Laundry.

THE PARTY PLAZA

by L.H.DESIGNS

The trick to making the most of a sprawling outdoor space? “I think about outdoor space the same way I do indoors,” says Los Angeles designer Linda Hayslett of L.H.Designs. **“Every area needs to have a purpose.”** The pool—a necessity in scorching hot Texas—became the central feature of the home’s patio, so she built her plan around it. A conversation area near the fireplace features a sectional and some youthful (but adult-friendly) swings, and a grilling area was equipped with an outdoor beverage-and-wine fridge, sink, and its own dining table to make it the secondary “heart of the home.” An outdoor-rated quartz counter-top caps a massive island that’s got an ice bucket and beer tap built right into the surface. With a little extra room to spare, Hayslett created a few more zones: a spot for billiards, a massive wood-burning firepit, and even an outdoor shower for quick clean-offs just out of sight.

Sectional, patterned pillows, swing chairs, and rattan lanterns: [Serena & Lily](#).
Ottoman: [Arhaus](#). **Rug:** [Fibreworks](#). **Firepit chairs:** [World Market](#).





POOL TABLE
Under the covered patio, a custom outdoor pool table is ready—rain or shine.
Pool table: [R&R Outdoors](#).



OUTDOOR DINING ROOM
A built-in banquette, just opposite the cooking area, provides a more formal dining option. Dining table: [Arhaus](#). Counter stools, dining chair, and metal lanterns: [Frontgate](#).



GAME LAWN
A small patch of [AstroTurf](#) offers a no-maintenance surface for bocce ball or cornhole. Umbrella and chaise: [Arhaus](#). Stools: [Frontgate](#). Planters: custom [Caesarstone](#). Lawn games: [Walmart](#).



WATCH IT ALL GO DOWN
Tune in to *Blank Slate*, our new nine-part video series, to see how every single room in this house took shape. [housebeautiful.com/whole-home-2021](https://www.housebeautiful.com/whole-home-2021)

Dealer's choice: two beers on tap!

COVERED KITCHEN
Never one to skimp on storage, Hayslett added lower and upper cabinetry around the grill. "I wanted a place to put cups, tableware, and knick-knacks, so I designed a floating multitiered shelf and a cabinet for easily accessing everyday items," she says. Outdoor appliances: [Renaissance Cooking Systems](#) and [Acme Brick](#). Cabinetry, metalwork, and shelving: [Architectural Grille](#). Brick wall: [Acme Brick](#). Countertops: [Caesarstone](#). Pendants and sconce: [Circa Lighting](#). Rug: [Fibreworks](#). Exterior paint: [Farrow & Ball](#).

The Long ROAD HOME

Laid-back living by day. An entertainer's dream by night. It took a while to get here, but our fourth annual Whole Home is exactly where you'd want to end up.

THANKS TO OUR
PROJECT SPONSORS

ACME BRICK, ARCHITECTURAL GRILLE, ARHAUS, CAESARSTONE, CIRCA LIGHTING, CYNC, ELKAY, FABRICUT, FARROW & BALL, FIBREWORKS, GARAGE KINGS, GROTHOUSE, LG STUDIO, MORRIS & CO., PHILLIP JEFFRIES, SCHLAGE, SERENA & LILY, SIGNATURE HARDWARE, SIGNATURE KITCHEN SUITE, STEARNS & FOSTER, TENCEL, TRANE, THE RUG COMPANY, WALMART, WELLNESS WITHIN YOUR WALLS

writer & producer Carisha Swanson / photographer Stephen Karlisch
stylist Robert Rufino / builder Agave Custom Homes



BUILDING A HOUSE IN A PANDEMIC IS NOT EASY—BUT IT IS ESSENTIAL.

Ask any designer, contractor, or homeowner who's done a renovation in the past two years. Product and transit delays, material costs shifting weekly. It's enough to drive a design crew mad. But we had our mission—build the fourth annual Whole Home in just *four months*. Like so many families filing construction permits and navigating skyrocketing material prices this year, we kept reality in mind: It's never been more important to have a peaceful, productive, and restorative refuge to call home.

To pull this all off, we went to Fredericksburg, Texas, a German settlement with 175-year-old historic roots smack dab in the heart of Hill Country, and found a 750-acre "agrihood" community called Hidden Springs. There we teamed up with Tyler O'Brien of Agave Custom Homes, who was just insane enough to help us on our journey, and set about proving that building a dream home in a pandemic *is* possible.

O'Brien's plan was to build a single-story, Craftsman-inspired farmhouse with two separate wings and an expansive outdoor area. The design is meant to be connected to the landscape, where livestock roam

freely on a 30-acre nature preserve.

But in true *House Beautiful* style, we wanted to give the house more of a purpose—after all, for the past 125 years, this brand has understood that design is as much about humanity as it is about vanity. We enlisted eight Next Wave alumni from across the country to help us define and refine what today's ideal home should be.

Each designer brought a distinct point of view to their assigned space.

From a sunrise-inspired living room that sets an uplifting tone for the whole house, to a cozy kitchen for long, lingering conversations, to a massive party patio fully equipped to go from candlelight to cornhole, every inch has a purpose. During a year in which our homes had to be offices, classrooms, and still (somehow) personal sanctuaries, this one is tailor-made to foster work, play, and pressing pause. ■

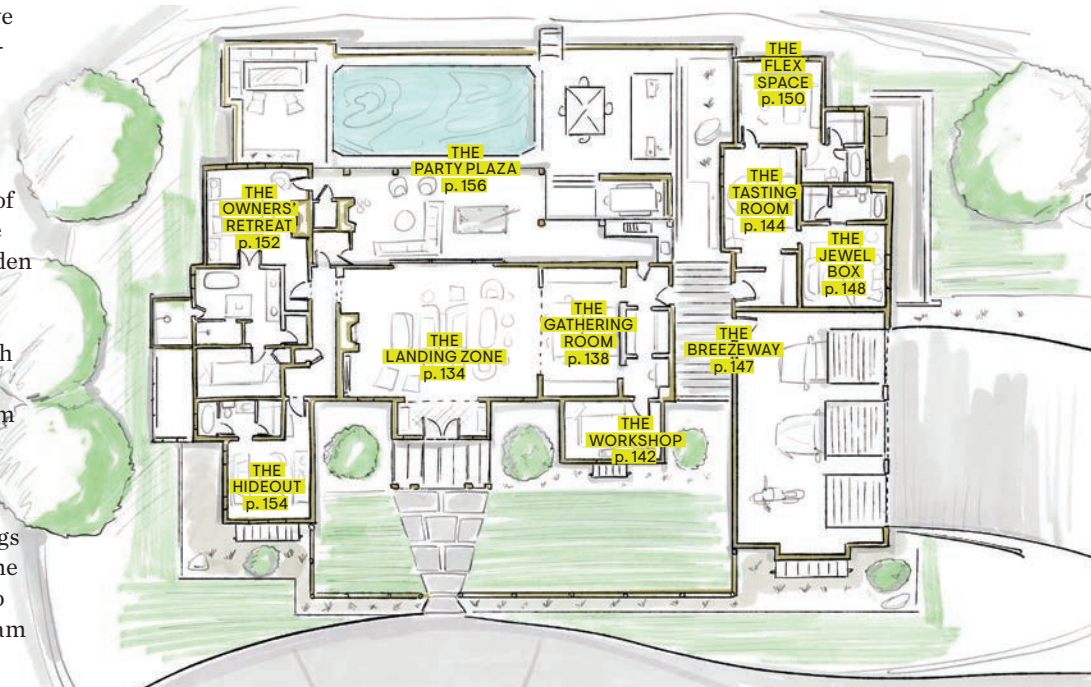

ILLUSTRATION: BRETT AFFRONTI, STYLE ASSISTANT: JONATHAN TRIVINO

ENTRYWAY

A collection of nine botanical prints over an ombré wallcovering sets the tone. Bench: *Serena & Lily*. Wallcovering: *Phillip Jeffries*. Pendants: *Circa Lighting*. Pillows and throw: *Anthropologie*. Art: *Simon Breitbard Fine Arts*. Tile: *Granada Tile*.





SITTING AREA

Sling chairs in a whimsical watercolor print sit in a colorful corner near the fireplace. **Chairs:** [Croft House](#). **Upholstery fabric:** [CW Stockwell](#). **Vases:** [Serena & Lily](#).



ENTRYWAY

The opposite side of the foyer provides storage and a mirror to check your lipstick (this is Texas!) before exiting. **Credenza:** [Croft House](#). **Mirror:** [Anthropologie](#). **Vases:** [Design Within Reach](#). **Planter:** [Eclectic Home](#).



LIVING ROOM

Inspired by the sunrise, Munroe created a custom wallcovering mural that showcases a prismatic color scheme and functions as art. **Coffee table:** [Croft House](#). **Rattan stools:** [Article](#). **Wallcovering:** [Phillip Jeffries](#). **Chandeliers:** [Circa Lighting](#). **Paint:** [Farrow & Ball](#).

THE LANDING ZONE

by **STUDIO MUNROE**

Everything really is bigger in Texas. Clocking in at a cavernous 700 square feet, the living room (originally conceived of as a combined living and dining room) features a 20-foot-high vaulted ceiling and a whole wall of glass doors leading to the patio. Undeterred, Emilie Munroe of the San Francisco firm Studio Munroe set about making the massive space and adjoining vestibule more warm and inviting. **“I thought, *Let’s be bold, let’s be colorful, let’s be vibrant and forward-thinking and create a magical environment for welcoming people into this home,*”** she recalls. Grounding colors set the tone: a deep sea blue on the walls, with inky black for the brick fireplace. And on either side of the hearth is a multicolored wallcovering depicting clouds during a dramatic sunrise, a color scheme that’s replicated in the ombre print in the entryway—and the rest of the room’s furnishings. Back-to-back tuxedo sofas feature stripes in two directions, while pops of sunny yellow, lavender, and fuchsia are peppered throughout in pillows, side tables, and accessories. Two subtle color-blocked rugs define and anchor the two conversation areas. **“When I design with lots of colors, I like to think of it like a dinner party. You want to have a mix of personalities, but they all get along,”** Munroe says. **“And no one commands too much attention.”**

Wallcovering: [Phillip Jeffries](#). **Rattan side tables:** [Serena & Lily](#). **Chairs:** [Mitchell Gold + Bob Williams](#). **Drinks tables:** [Design Within Reach](#).

LIVING ROOM

To personalize the enormous room, Munroe skipped a sectional in favor of two separate conversation areas: one for fireside convos and the other for playing games or patiently waiting on dinner from the adjoining kitchen. **Paint:** Farrow & Ball.

Sofa: Evan Spencer, in Fabricut fabric. **Woven tables:** Serena & Lily. **Coffee tables:** Arhaus (gray), Croft House (yellow). **Rugs:** The Rug Company. **Console table:** custom, Caesarstone. **Lighting:** Circa Lighting. **Drapery:** The Shade Store. **Door handle:** Schlage. **HVAC:** Trane.

An extra-long rod allows drapes to be drawn across all the windows.

THE GATHERING ROOM

by SABBE INTERIOR DESIGN

No kitchen is *just* for cooking. There's no better place to vent, celebrate, or simply catch up about the events of the day than near snacks. "My grandmother had a dining table in the middle of her kitchen, and we sat there for hours and experienced life together," recalls designer Stephanie Sabbe of Sabbe Interior Design in Nashville. So instead of dropping an extra-large island in the middle of this space, she introduced a proper dining room table that could comfortably seat six. Then Sabbe decorated the kitchen like any other room in the house, adding a charming leaf-motif wallpaper, traditional wingback chairs (bought upholstered from an online consignor), and blue-green paint on the cabinetry and ceilings. A dark quartz countertop and backsplash keep the room feeling sophisticated.

Appliances: [Signature Kitchen Suite](#). **Fixtures:** [Elkay](#). **Countertop and backsplash:** [Caesarstone](#). **Table and range hood:** [Grothouse](#). **Paint:** [Farrow & Ball](#). **Wallpaper:** [Morris & Co](#). **Lighting:** [Circa Lighting](#). **Rug:** [Turkish Carpets Inc](#). **Door handle:** [Schlage](#).



DIRTY PANTRY

Situated behind the main kitchen so as to hide the cooking mess, this space also houses a second dishwasher, undercounter microwave, and wall oven. Countertop-to-ceiling custom shelving adds an elegance and warmth to this narrow room, and keeps snacks and dishware easily accessible. **Wood countertop and shelves:** Grothouse. **Appliances:** Signature Kitchen Suite. **Fixtures:** Elkay. **Lighting:** Circa Lighting. **Paint:** Farrow & Ball. **Wallpaper:** Stroheim. **Floors:** Acme Brick. **Storage containers and tableware:** Walmart.



ENTRANCE
 "I wanted to celebrate and display how two spaces adjacent to each other could take on a different flavor," says Sabbe, who designed a glass transom wall to separate the living room and kitchen. "Every room should be its own experience, and boundaries help." **Fixtures:** Elkay. **Countertop:** Caesarstone.

HIDDEN FEATURES
 A 48-inch range, equipped with gas, induction, and sous vide settings, sits proudly under a bespoke wood hood. Custom cabinetry panels disguise fridge and freezer columns. **Appliances:** Signature Kitchen Suite. **Hood:** Grothouse.

RECIPE DESK

A quiet nook for early morning coffee and to-do's. **Desk:** Grothouse. **Lighting:** Circa Lighting. **Paint:** Farrow & Ball. **Vent cover:** Architectural Grille. **Chair:** vintage.



THE WORKSHOP

by SABBE INTERIOR DESIGN

When Sabbe first reviewed the floor plans for what was basically the home's utility room, she knew it had so much more potential. "I saw it as being a laundry room, dog-washing room, gift-wrapping room, potting station, flower-cutting area, extra storage...basically a catchall for anything functional you do in the house," says Sabbe. Infusing the space with a warm, saffron-yellow paint on the cabinets and wainscoting, and topping that with a simple botanical wallcovering, elevated it from a glorified closet to a place you'd actually like to be. Hard-wearing brick floors and a convenient doggie shower station (which is also good for washing off muddy cowboy—or cowgirl—boots) make it truly multipurpose.

Countertop: [Caesarstone](#). Wallpaper: [Morris & Co.](#)
Paint: [Farrow & Ball](#). Fixtures: [Elkay](#). Lighting: [Circa Lighting](#). Flooring: [Acme Brick](#). Storage containers and tableware: [Walmart](#).



^ PET SHOWER

After running amok throughout the local terrain, the family dog can come in for a little wash down. (Hi, Tex!) **Fixture:** [Elkay](#). **Tiles:** [Daltile](#).

> LAUNDRY CORNER

To maximize countertop space for this multiuse room, Sabbe chose a single-unit washer-dryer with all the controls for both at eye level. **Appliance:** [LG Studio](#). **Bowl filler:** [Elkay](#).

